



HOLE		1	2	3	4	5	6	7	8	9	OUT
BLACK	72.3/126	462	414	365	225	489	359	189	541	427	3471
BLUE	71.2/123	409	404	360	191	483	353	184	535	400	3319
PAR		4	4	4	3	5	4	3	5	4	36
HANDICAP		5	9	13	17	3	11	15	1	7	
											
+/-											
WHITE	69.6/119 (M) 75.0/130 (W)	383	372	354	170	414	346	179	528	383	3129
YELLOW	65.3/112 (M) 69.9/118 (W)	312	278	282	153	401	339	173	417	330	2685
PAR		4	4	4	3	4/5	4	3	5	4	35/36
HANDICAP		7	13	11	17	3	15	15	1	9	1
SCORER											

 **USGA Pace of Play:** 4:10 for 18 holes. Play ready golf.  
Suggested Tee for Handicap: 0-5 Black; 6-13 Blue; 14-24 White; 25+ Yellow

**Course Etiquette:** Keep your golf car and pull cart at least 30 feet from greens and tees. Replace divots. Rake bunkers. Repair ball marks.

10	11	12	13	14	15	16	17	18	IN	OUT	TOTAL	HDCP NET
456	430	354	148	516	389	224	341	480	3338	3471	6809	
449	422	346	143	143	380	215	332	472	3264	3319	6583	
4	4	4	3	3	4	3	4	5	36	36	72	
6	8	10	18	18	12	16	14	4				
												
442	337	339	137	495	371	183	321	456	3081	3129	6210	
339	329	212	131	428	301	177	233	448	2598	2685	5283	
4	4	4	3	5	4	3	4	5	36	35/36	71/72	
6	10	8	18	2	14	16	12	4				
ATTEST						DATE						

18-hole play is continuous. If you fail to report to the 10th tee, you will lose your position.

Join us in the Clubhouse! Enjoy sandwiches, beer, and more.  
Carry-in food and beverages are not allowed on the course.

Scott Walecki PGA Professional  
Mike Stein, GCSAA, WGCSA

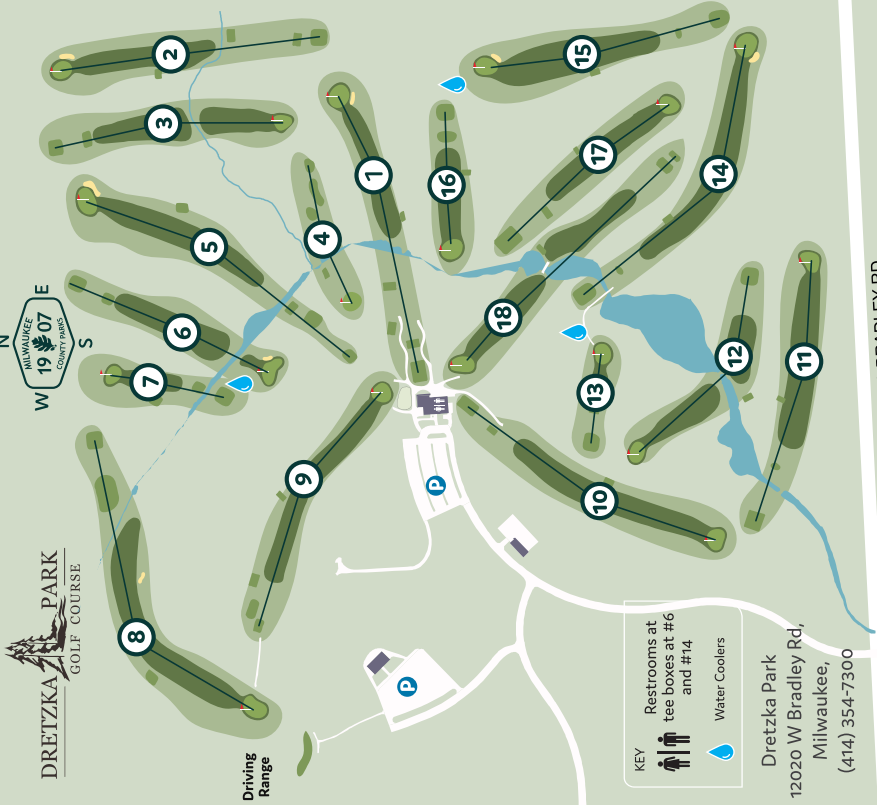

**KEY**  
 Restrooms at tee boxes at #6 and #14  
 Water Coolers

Dretzka Park  
 12020 W Bradley Rd,  
 Milwaukee,  
 (414) 354-7300

W. BRADLEY RD.



**MILWAUKEE COUNTY GOLF**

**DRETZKA PARK**  
**GOLF COURSE**

RESERVATIONS:  
 414.354.7300 OR [MKE.golf/dretzka](http://MKE.golf/dretzka)